



## **Technical Bulletin 045**

### **Bull Pull Hitch Bolts**

Page 1 of 3

It has been noted that under some circumstances machines fitted with the Bull Pull tow hitch can experience premature failure of the 1" X 5-1/2" UNF Grade 8 ZP fastening bolts when they are installed with the nuts on the bottom side of the hitch. When assembled like this the threads align with the shear load of the assembly.

It is recommended that the following steps be carried out.

Tools required for completing this Tech Bulletin:

- 2 x 1-1/2" x 3/4" drive socket
- 1 x 3/4" drive torque wrench
- 1 x 3/4" drive socket bar

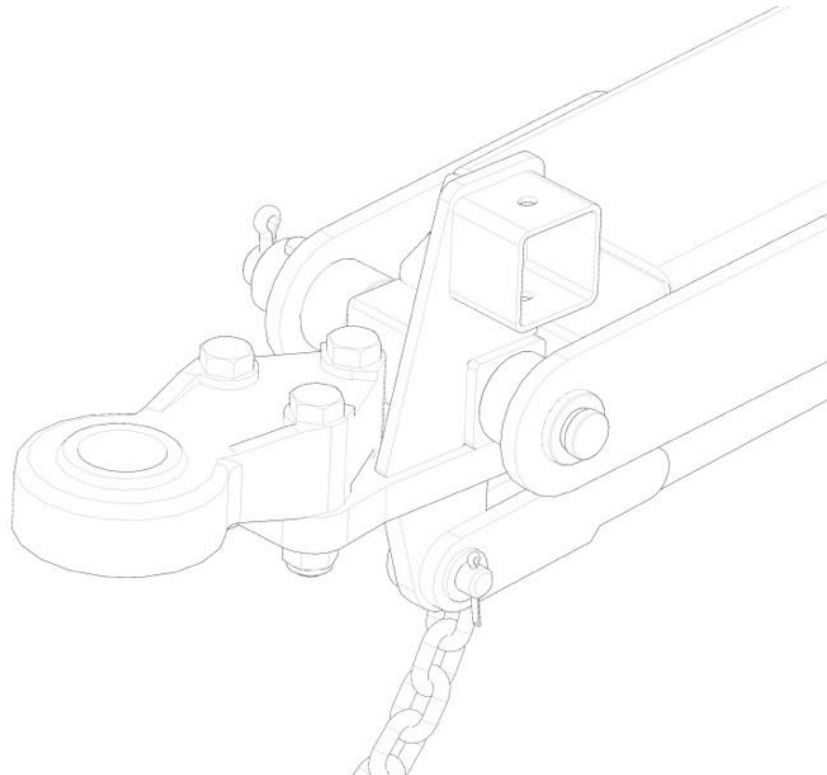

**Bull Pull Hitch Bolts**

Page 2 of 3

1. Remove the bolts and inspected for any signs of wear or cracking.

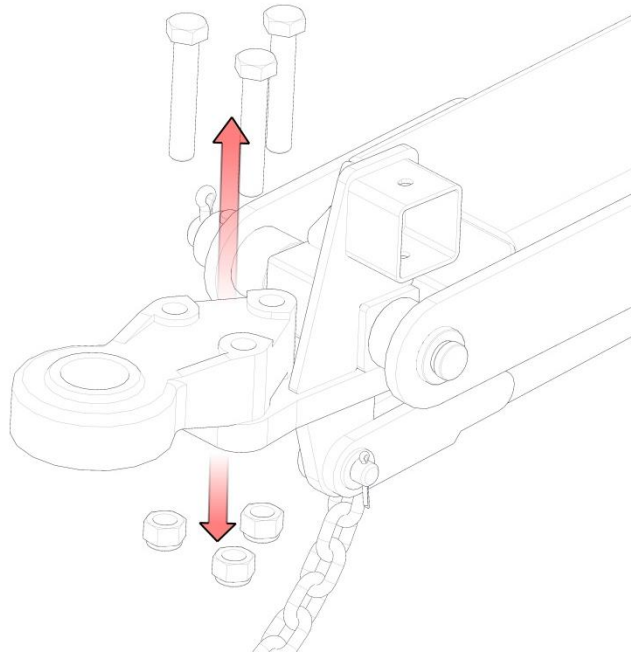

2. If the bolts are still in good condition reinstall from the under side of the hitch.

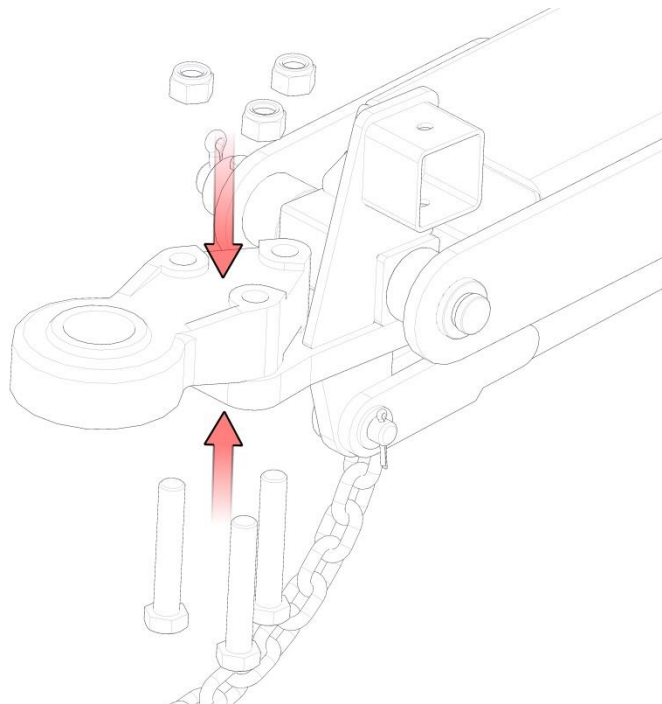

Bull Pull Hitch Bolts

Page 3 of 3

3. Re torque the bolts to the required torque setting.

